

\$185,000 - 607 Railway Avenue W, Hanna

MLS® #A2126232

\$185,000

0 Bedroom, 0.00 Bathroom,
Land on 0.90 Acres

Hanna, Hanna, Alberta

Check out this prime commercial lot available right along the main entrance to town. Great location to attract travelers off highway 9 with quick access to and from the highway entrance. Be one of the first businesses people see as they drive into town.



Essential Information

MLS® #	A2126232
Price	\$185,000
Bathrooms	0.00
Acres	0.90
Type	Land
Sub-Type	Commercial Land
Status	Active

Community Information

Address	607 Railway Avenue W
Subdivision	Hanna
City	Hanna
County	Special Area 2
Province	Alberta
Postal Code	T0J1P0

Additional Information

Date Listed	April 28th, 2024
Days on Market	186
Zoning	Highway Commercial

Listing Details

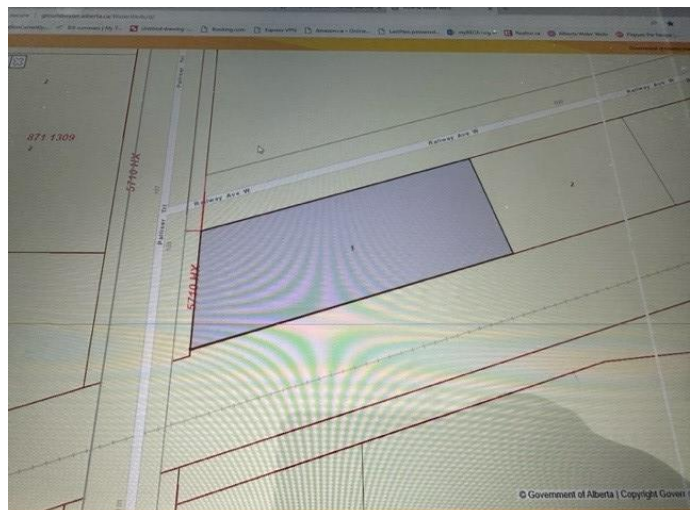

Listing Office

eXp Realty

Data is supplied by Pillar 9â,,ç MLSÂ® System. Pillar 9â,,ç is the owner of the copyright in its MLSÂ® System. Data is deemed reliable but is not guaranteed accurate by Pillar 9â,,ç. The trademarks MLSÂ®, Multiple Listing ServiceÂ® and the associated logos are owned by The Canadian Real Estate Association (CREA) and identify the quality of services provided by real estate professionals who are members of CREA. Used under license.